

43 Lynchet Close

Brighton, BN1 7FP

Asking price £295,000

Positioned in a quiet close is this well maintained 2 bedroom freehold house, which has been refurbished by the current landlord and rented out. Accommodation comprises 2 bedrooms, spacious kitchen, reception area and bathroom with bath and shower. There is also a private rear garden with a decking area and lawn. The property also benefits from having an off-road parking space.

Lynchet Close is set within a popular residential area with local amenities nearby in Hollingdean and Fiveways. There are nearby transport links to the city centre and to universities.



- Two bedroom house
- Chain Free
- Private garden
- 499 Sq ft
- Freehold
- Popular location
- Off-road parking space
- Currently Rented

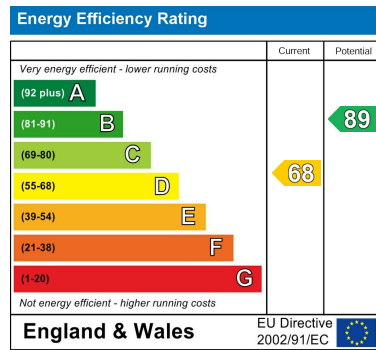

LYNCHET CLOSE

Approx. Gross Internal Floor Area = 46.38 sq m / 499.22 sq ft
 Illustration for identification purposes only, measurements are approximate, not to scale.

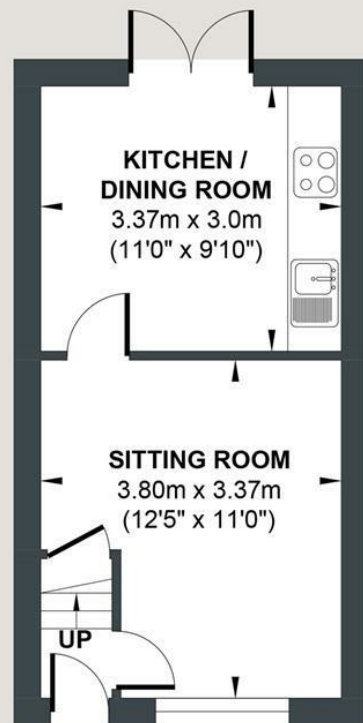

GROUND FLOOR

Approximate Floor Area
 249.61 sq ft
 (23.19 sq m)

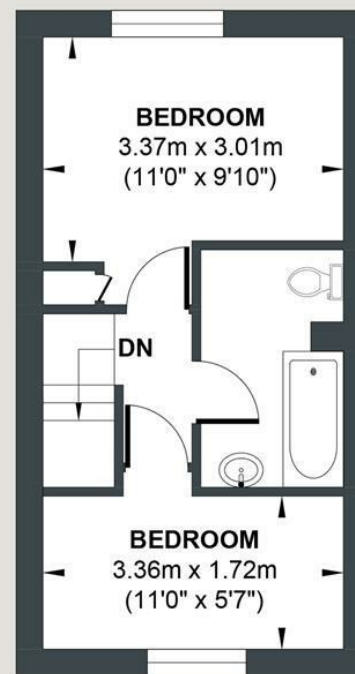

FIRST FLOOR

Approximate Floor Area
 249.61 sq ft
 (23.19 sq m)

